

Cabinet and Commissioner Decision Making Meeting: 12th December 2016

Boston Park Reservoir

APPENDIX 1

Site Location

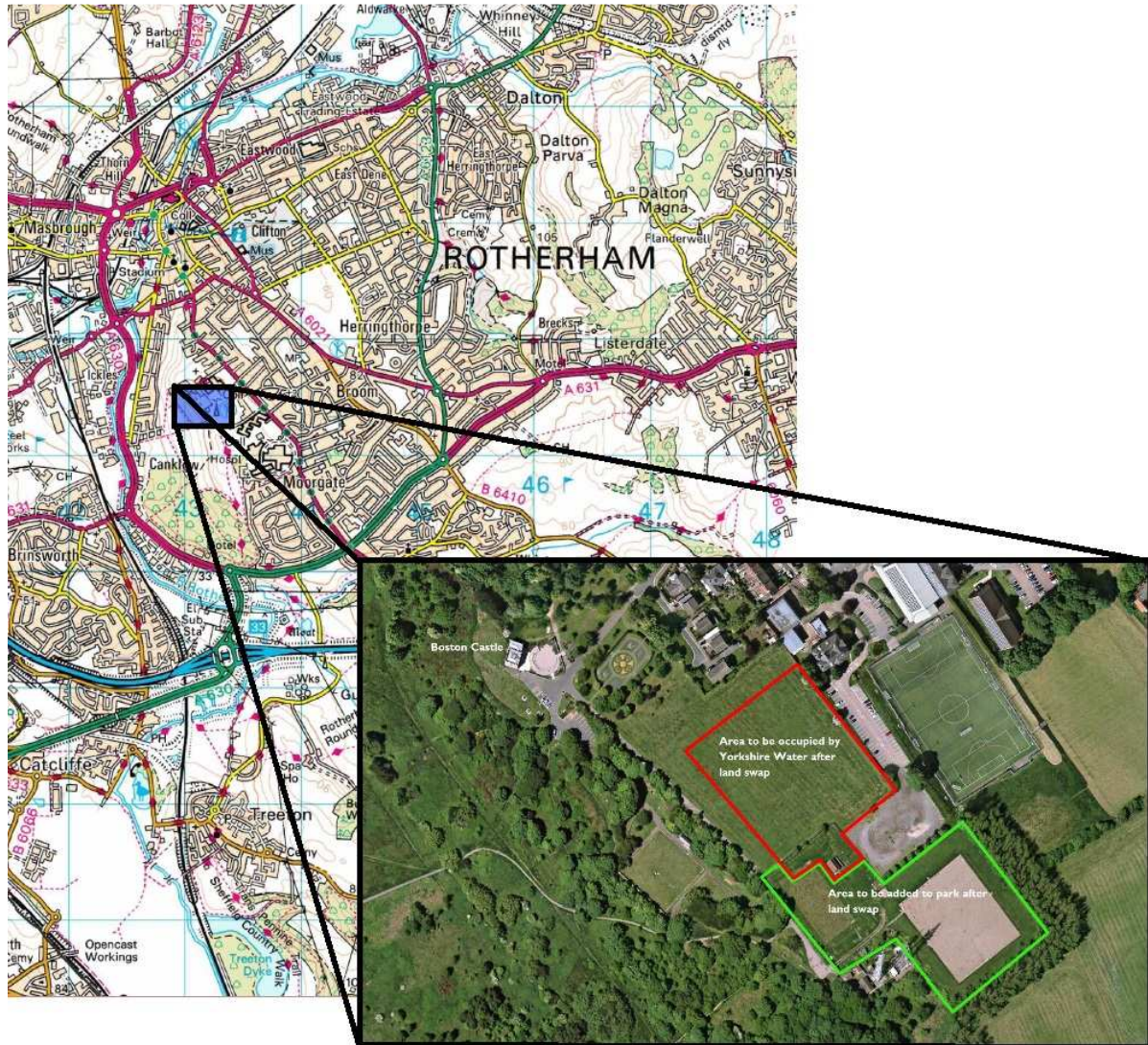

Site Layout

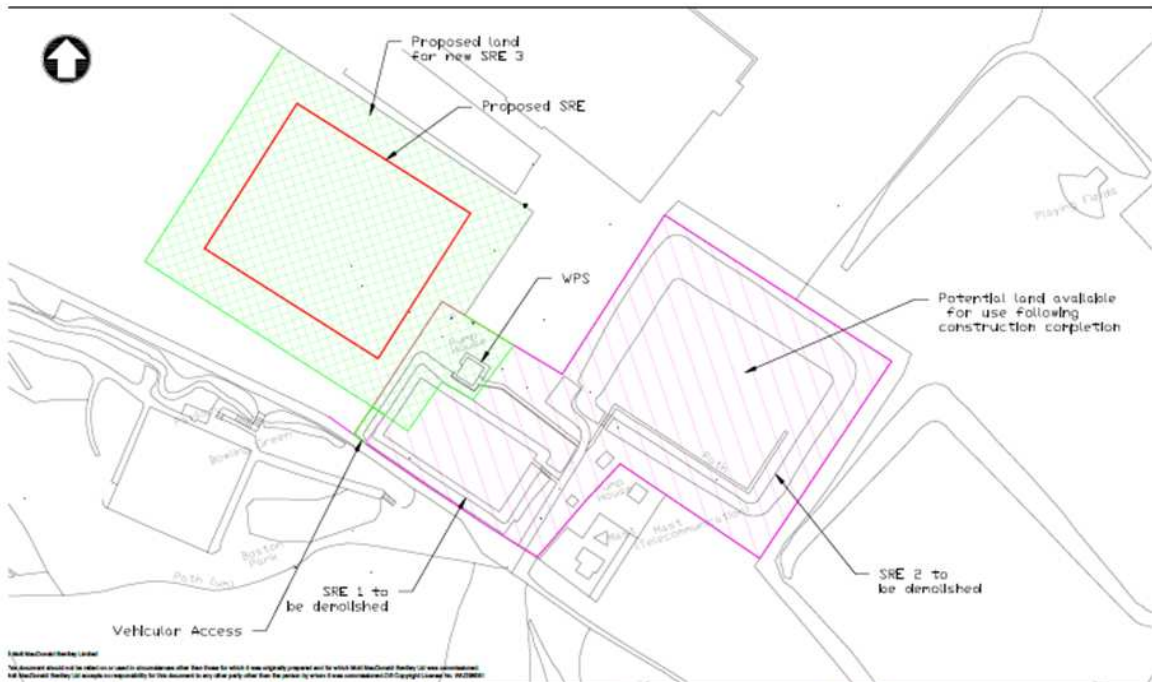

MMB MacDonell Bentley Limited
 This document should not be relied on or used in accordance with the terms for which it was originally prepared and for which MMB MacDonell Bentley (or its subsidiaries)
 or MMB MacDonell Bentley (or its subsidiaries) accept no responsibility to any other party other than the person to whom it was submitted (TS) Copyright (c) MMB 2022

MMB AMP3 - Asset Delivery Unit MMB MacDonell Bentley Limited 10000 Highway 70 Scarborough, ON M1V 4Y7 Tel: (416) 291-1000 Fax: (416) 291-1001 Email: info@mmb.com	Client Yorkshire Water 100, 101, 102, 103 3044 7th L.A. St. N.	Rev	Date	Drawn	Description	Chk'd	App'd	Title Boston Park SRE Investigation 12M SRE
		P1		GG	Preliminary Issue			
Stream: <u>Seabrook</u> Batch No: <u>N502</u> Scheme Address: <u>Boston Park SRE</u> <u>"Boston Park" off Sutton Castle Grove</u> <u>Ilkeston, S82 2UB</u>	YWB Ref: <u>0202</u> OGA: <u>-</u> OG Ref: <u>SK-01-913</u> OGA: <u>TSC</u>	Design:		GG	Engineering Check.			Scale of A3 NTS
			CAD Technician:	GG	Lead Batch Designer Check.			
		Specialist Check:	-	Design Manager Approval				Drawing No: N502-01-SK-022
								Rev Status P1 INF